

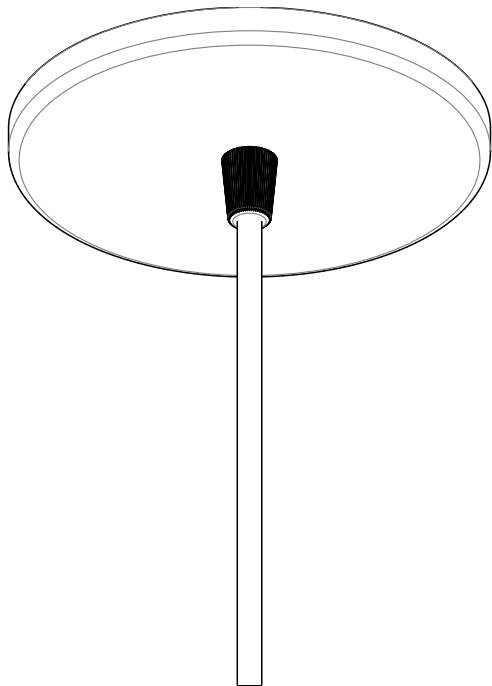

Flat Canopy

15675 rA

Round
Cord Suspension



CAUTION:

Before starting, turn off power
at main circuit panel.

ADVERTENCIA:

Antes de comenzar la instalación,
apague la corriente en el tablero
principal.

ATTENTION:

Coupez l'alimentation avant de
procéder à l'installation.



Calling for backup? Scan above
to contact our team.

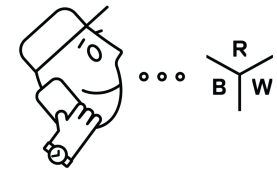

www.RBW.com

+1 212 388 0399

support@RBW.com

© RBW Studio LLC, 2013, 2020

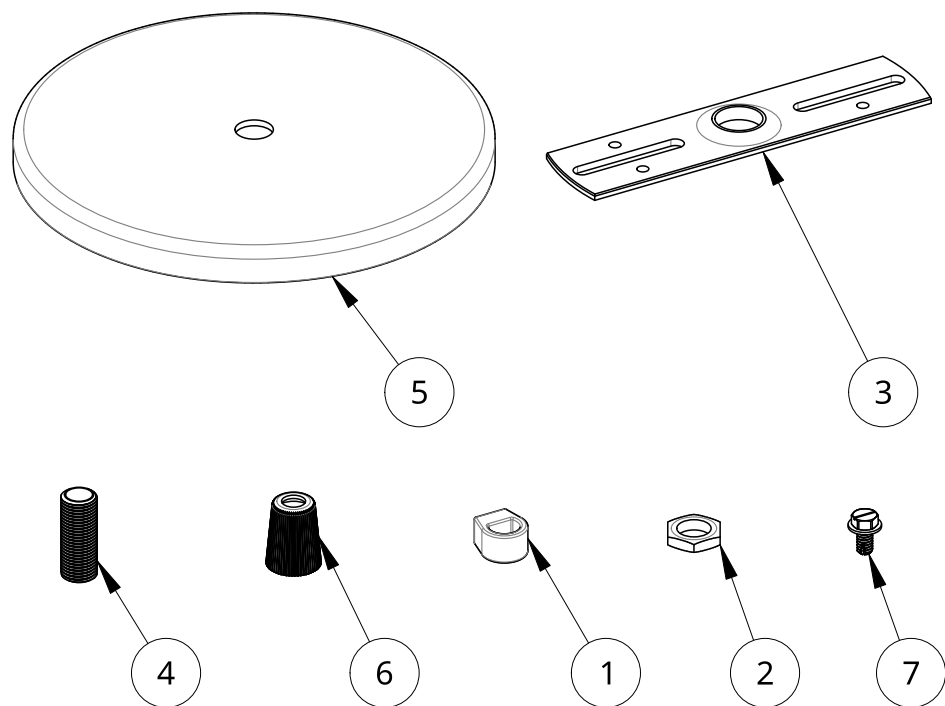

Item	Qty	Part number	Description
1	1	BG505W	White Nylon Strain Relief
2	1	10869	Hex Nut 1/8-27 IPS Zinc Plated
3	1	10782	CrossBar #178/#58
4	1	11226	1 in X 1/8 IPS Threaded Brass Hollow Nipple
5	1	10881-PC20	Round Canopy #93. Cable Mount. White
6	1	STE5905A	M10 Conical Grooved Nut Plastic White
7	1	92597A800	8-32 x 5/16" Electrical Grounding Screw

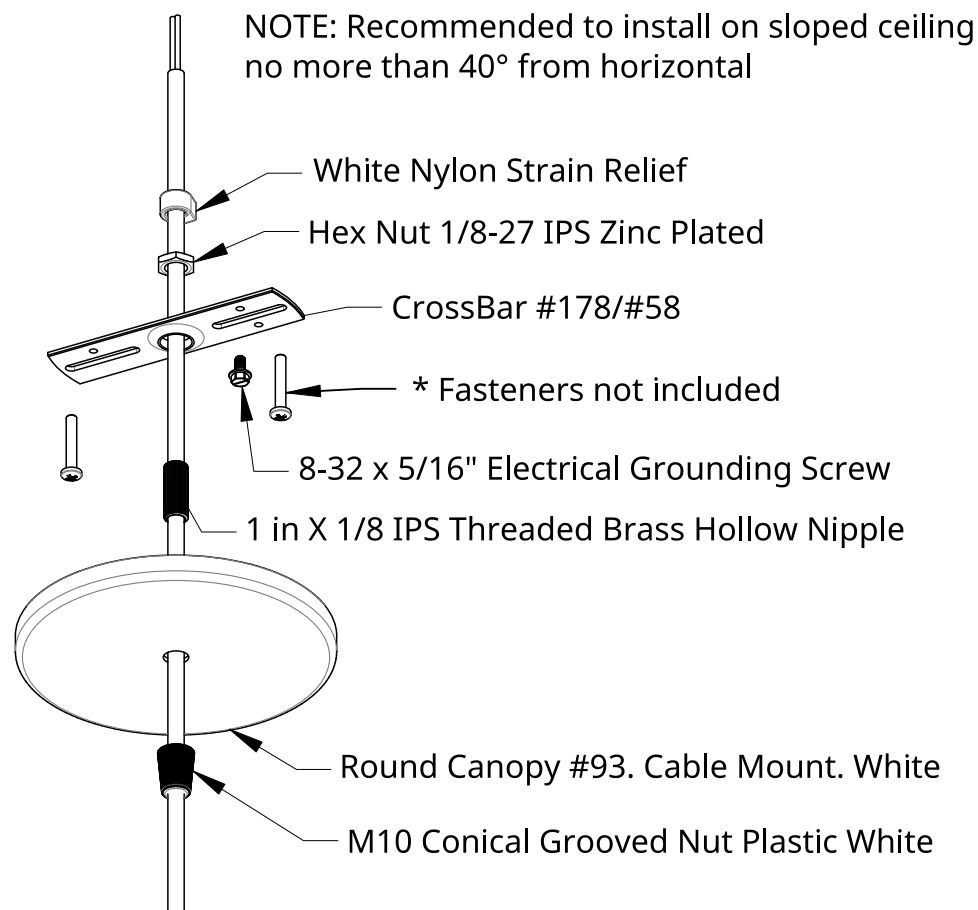

Installation - Flat Round Canopy

1. Thread Brass Nipple through the Crossbar and thread Hex Nut onto Brass Nipple.
2. Slide the Conical Nut, Round Canopy, Nipple, Crossbar, Hex Nut and Strain Relief over Power Cord.
3. Fasten Strain Relief at desired hang height by tightening the set screw.
4. Fasten Crossbar to the junction box.
5. Trim and strip excess power cord.
6. Connect to power feed.
7. Raise Round Canopy and thread Conical Nut onto 1/8 IPS Nipple.
8. Congratulations! End of guide.